

# ROAMING GUIDANCE "Network Mode" Setting for Android & IOS

When You Are Roaming in  
**SINGAPORE**  
by using "SIMBA" network

## ■ Network Mode Setting for Android

\*Menu naming may differ depending on the type of handset used

### 1 Go to SETTING

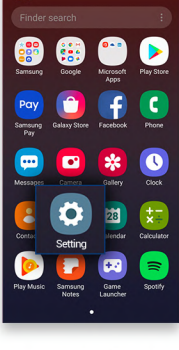

### 2 Select CONNECTION/ MORE/DUAL SIM & CELLULAR NETWORK

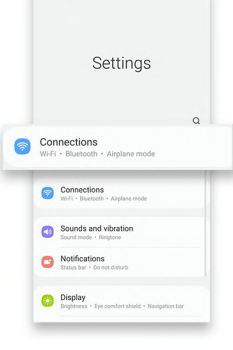

### 3 Select MOBILE NETWORKS/CELLULAR NETWORK/SIMI

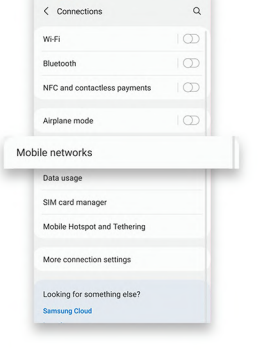

### 4 Select NETWORK OPERATORS

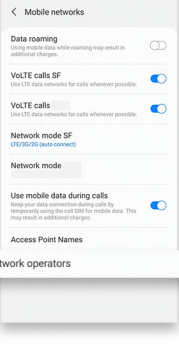

### 5 Make sure to deactivate the SELECT AUTOMATICALLY menu then select AVAILABLE NETWORKS using SIMBA

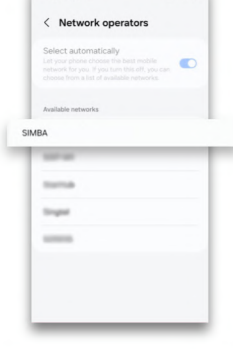

## ■ Network Mode Setting for iOS

iPhone 7+, \*iOS device version 11 and above

### 1 Go to SETTING



### 2 Select CELLULAR

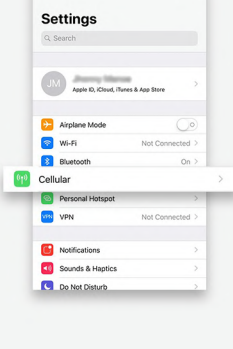

### 3 Select NETWORK SELECTION

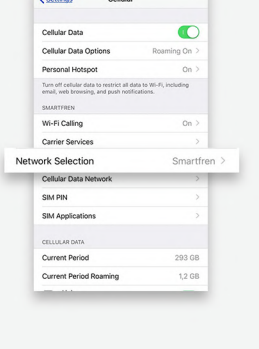

### 4 Make sure to deactivate the AUTOMATIC menu then select the available network using SIMBA



## ■ eSIM Network Mode Setting for iOS

iPhone X+, \*iOS device version 12 and above

### 1 Go to SETTING



### 2 Select MOBILE DATA

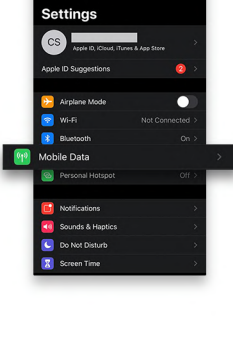

### 3 Make sure MOBILE DATA (A) & DEFAULT VOICE LINE (B) use the same DATA PLAN (C) used by smartfren

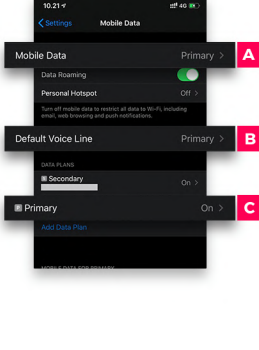

### 4 Select NETWORK SELECTION

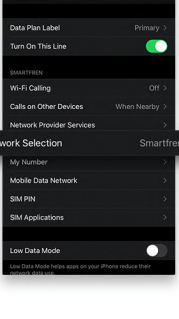

### 5 Make sure to deactivate the AUTOMATIC menu then select the available network using SIMBA

